

DENDOUMARU 4000HP

INSTRUCTION MANUAL

Thank you for purchasing Shimano's Dendoumaru 4000 HP.

Before using, please read this manual carefully, and the same as you do for your reel, keep it with care.

Features	2	High-cut repair	18
Digital counter parts name	3	Gunnel stop	19
Main switch	4	Motorized reel, speed-switch usage	21
Name of each part	5	Rack setting	22
Power source and cord	6	Rack-setting:Top Mode & Bottom Mode	23
Learning method	7	Top Mode fishing example	24
Learning method 1. When winding line other than Shimano Antares 50lbs.-600m (Learning Mode)	9	Bottom Mode fishing example	25
Learning method 2. Winding Shimano ANTARES 50lbs.-600M (Specify Mode)	11	Handling precautions/safety functions	26
Sequence	12	Specifications, inquiry, after-sales-service	28
Various techniques	14	Trouble-shooting	29
Zero-setting	16	Safety precautions	30
		Service network	31

Features

Surpassing
the previous
6000 Class
Instant Max. Torque
44kgcm
DENDOMARU 4000HP

Surpassing the previous 6000 Class

Instant Max. Torque 44 kgcm.

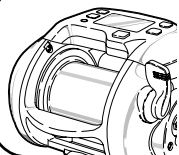

**SHIMANO ANTARES 50lbs.-600M
with reserve power.**

Enhanced spool-size for max. satisfaction



Superior visibility & operability...

Large LCD & control buttons

See P.3

Double-click

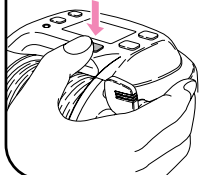

Continuous winding & frequent winding...

Double-click operation changeover

See P.4

When the motor is off, switch to the double-click mode for winding-up by simultaneously pressing the HIGH and LOW buttons for 3 sec. or more.



Washable. Drag comes with carbon-washer, water-resistant

Wash and keep.

See P.26

After wash, spray some oil. Long-life drag with carbon-washer.



Computer-controlled: 10-160m/min.

**One-touch Switch 15-speed
winding-up.**

See P.3, P.21



The hook aims precisely at the rack

Rack memory.

See P.22

Once the rack memory is taken, when the hook approaches it again, alarm will sound to announce approach to the rack.



Speedy wind-up

Hi-speed empty wind-up 160m/min.

Provides empty hook hi-speed wind-up, enabling fast return or change of position.

See P.21



Hook dropping to precise water-depth

Zero-setting.

See P.16~17

When the hook is on the water surface, it can be set as 0-meter, then dropped to precise water-depth.



When the pole is erected, the hook returns

Gunnel stop.

See P.19~ 20

Gunnel stop position is set automatically. After gunnel stop, erect the pole and the hook returns.



One-touch line-cut repair.

Line-cut setting.

See P.18

When the line is cut, re-connect hook, do zero-setting on the surface by pressing 0-set switch. The counter will recover.



Fast, precise search for rack

**SLSII installed (Shimano Line-Program
System 2).**

See P.8~11

Roller has been removed from reel unit, hook dropping is fast, and no slip caused by roller.



Counter display can be selected.

**Switching between "Top Mode"
and "Down Mode".**

See P.23

Depending on fishing location, method, and target catch, water-depth indicator can be switched - from top (surface) to bottom.

Digital Counter Component Names

- Note: The drawing shows all LCD light-up for explanation purpose only.

Top/Bottom switch

One touch
In standard mode, pressed once, and it switches from Top Mode to Bottom Mode.

Memo, Zero-setting switch

One touch
In Top Mode, the present water-depth goes to the memory. The same for Bottom Mode, the present depth is 0.0M, and it is counted from the bottom up.

More than 3 sec.
Zero-setting
Adjust the hook to the water surface and do zero-setting.

Mode switch

One-touch on the front tiny bottom
It will switch in sequence from “学习 (Learning)” to “指定 (Specify)” to “下卷 (Wind-down)” at every push.
Note: Wind-down mode does not apply to this model specifications.

Present water-depth

“Top Mode”: Depth measured from top.
“Bottom Mode”: Depth measured from bottom.
Note: Do not let out 999m or more of line. Doing so will result in inaccurate count values.
Note: Depth is measured in 10cm units. (When over 100m, the unit becomes 1 m as in the depicted below.)

99.9 → 100

Various display

It lights up at each mode:

学习 (Learning), 指定 (Specify), and 下卷 (Wind-down).
Note: Wind-down mode does not apply to this model specifications.
Zero-setting: It lights up when you do 0-setting.

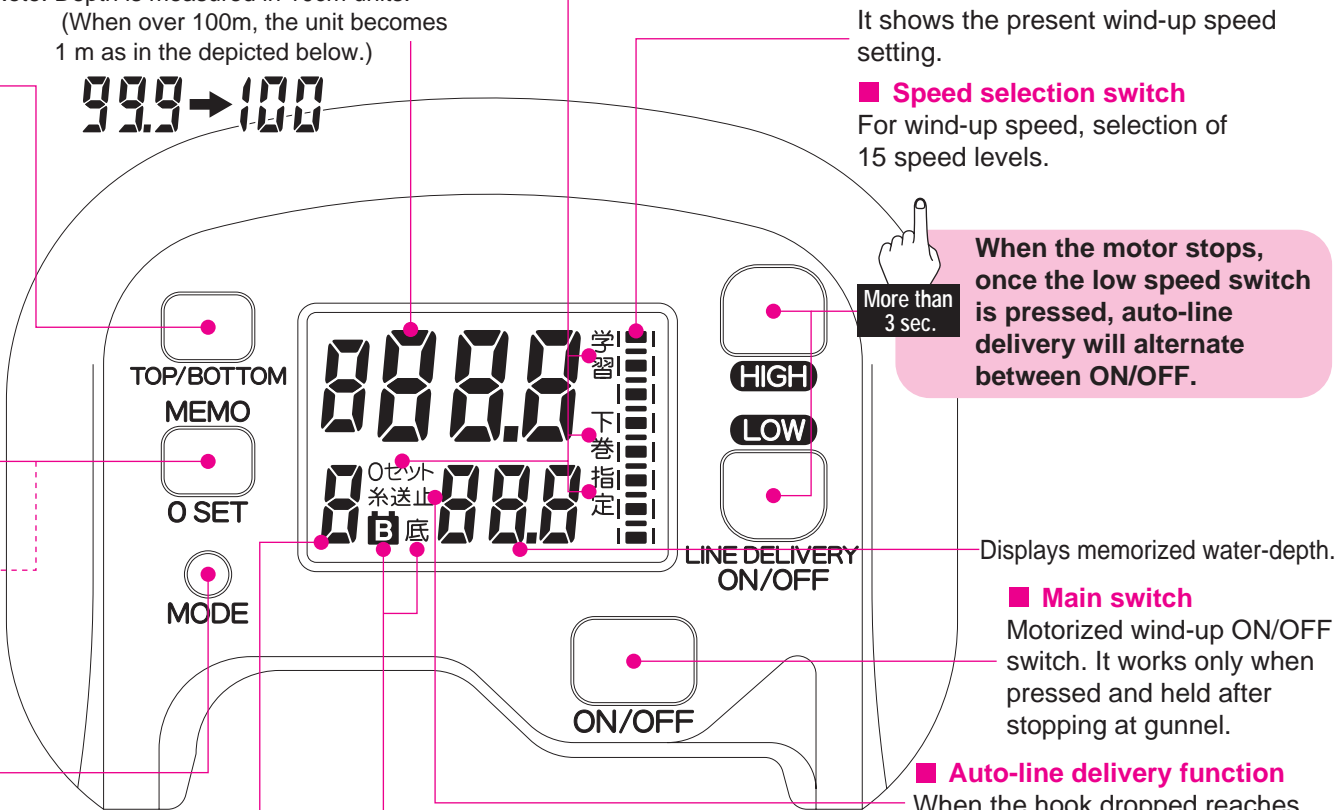

Wind-up power (line tension) is displayed in numbers. (the number is not kg)

Various display

底 (Bottom) : It lights up during “Bottom Mode”. When there is no light, it means “Top Mode”.
B: It will light up when the battery is weak. (below 10.5V)

It shows the present wind-up speed setting.

Speed selection switch

For wind-up speed, selection of 15 speed levels.

More than 3 sec.
When the motor stops, once the low speed switch is pressed, auto-line delivery will alternate between ON/OFF.

Displays memorized water-depth.

Main switch

Motorized wind-up ON/OFF switch. It works only when pressed and held after stopping at gunnel.

Auto-line delivery function

When the hook dropped reaches 10M, the motor will start turning automatically causing the spool to turn easily at line direction. When you OFF the function, “糸送止 (Line delivery stop)” indicator will light up.

Main Switch

Main switch for continuous winding, and frequent winding.

(The red switch component names are described on the right)



One touch

Press once:

continuous motorized wind-up will start. To stop, press once.

However, after stopping at gunnel, it will work only when you press and hold.



Double-click

When you press twice (double click)

at depths of 6.1m or more, and the motor will wind up the line until you release the button. Double-click for continuous wind-up.

※ For both the above, adjust the speed with speed switch.

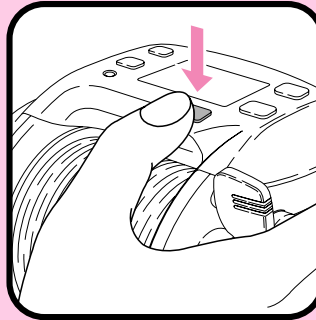

Press both simultaneously



More than 3 sec.

To switch to double-click mode...

Press the **HIGH** and **LOW** buttons at the same time for **3 sec. or more**

to exit the continuous wind-up mode and allow double-click operation. To return continuous wind-up mode, press the HIGH and LOW buttons again at the same time for 3 sec. or more. Even if the power is cut-off, it will not return to the original operation before you do this.



Continuous winding



Speed indicator mark changes like this.

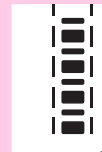

Double-click

● In this manual, when the following icon appears, it means....

Press the pointed button for **less than 3 seconds**.



One touch

Press the pointed button for **more than 3 seconds**.



More than 3 sec.

Press the pointed button **twice continuously (double-click)**

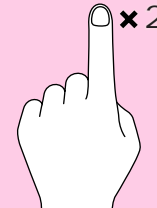

Double-click

Component Names

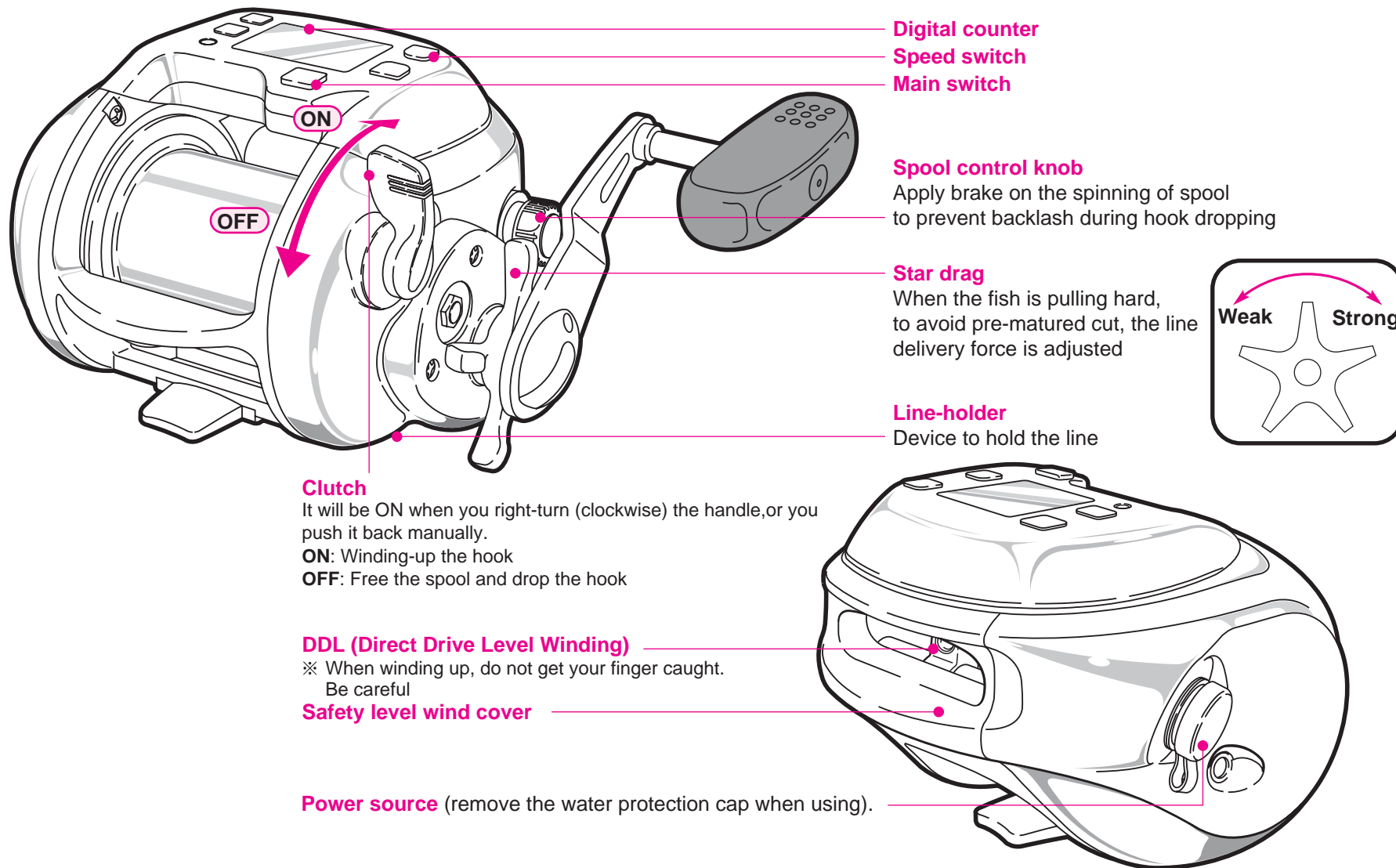

Power Source & Cord

1 Handling precautions

Power

The power source is 12V DC (Direct Current). (The capacity for usage is above 16,000mAh). Unspecified power source (such as AC 100V for household, or 24V DC available on board the vessel) cannot be used at all.

Absolutely do not use battery charger.

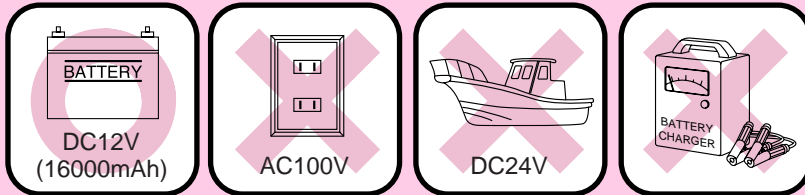

- When using the power source on board, make sure that the voltage is 12V DC (not directly from the vessel's battery, but use DC-DC Converter, from 24V to 12V). And when the battery poles are rusted, it may affect performance of reel, so remove the rust first before using.
- Use only battery that has been fully charged.
- After fishing, to protect the battery life, charge up first before storing. And before going out for fishing again, charge it up again before using.
- After using for a while, the charging capacity may deteriorate. In that case, replace the battery only.

Cord

When connecting to battery, always use Shimano genuine cord.

Precautions: When using non-genuine cord, the reel may not perform as expected. Besides that, do not misuse power cord. If you step on it, fold it, or bend it, damage may occur.

2 Connection to battery

- 1 First connect the cord supplied to the battery.**
As shown in the drawing, red clip to (+), and black clip to (-).

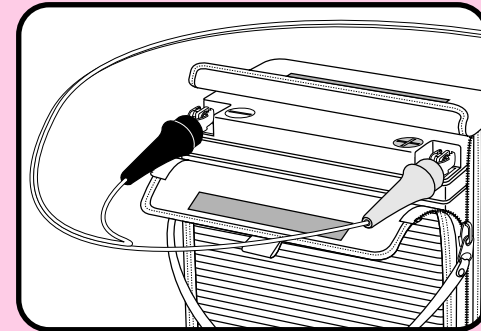

- 2 Next, connect reel to power cord.**
The recess of power cord to the protruding reel power connector, then press in and fasten the screw.

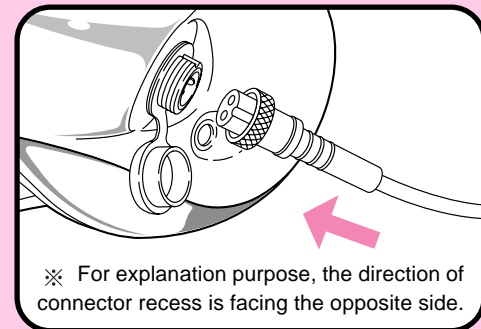

Learning Method

Line setting

- 1 Pass the line through the level winder. When passing the line, use the line-passing pin supplied.

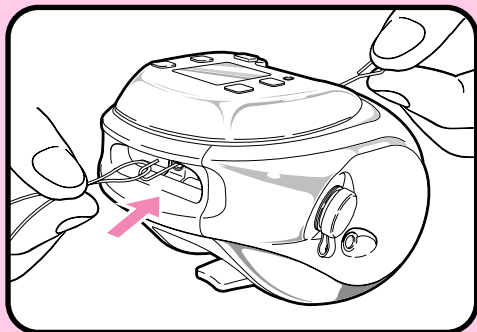

- 2 Tie the line to spool pin. The recess of power cord to the protruding reel power connector, then press in and fasten the screw.

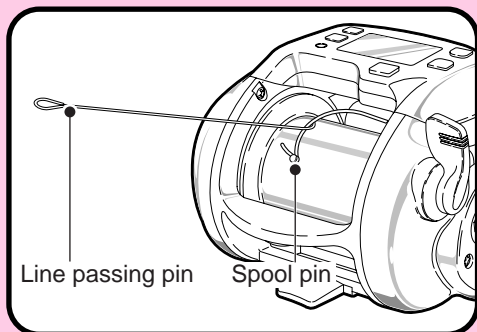

Mode switching

Every time you press the mode switch, it will switch as shown below. Select the mode that matches the type of line used. (See explanation in the next page).

※ To operate it, power source 12V must be connected

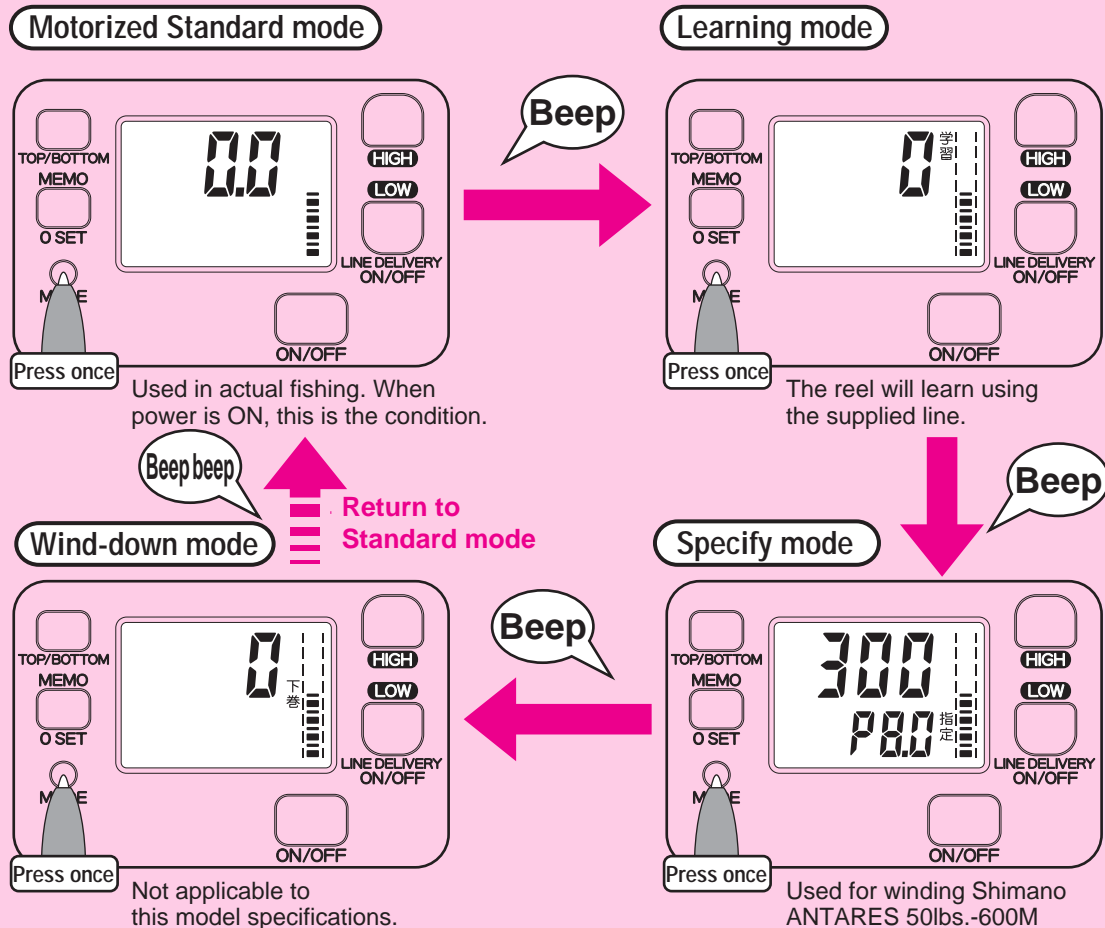

Learning Method



Things you should do before starting to wind is explained in the flow diagram below.

“As shown here, there are 2 methods available (1~2). For detail explanation of each method, refer to respective pages.”

※ It can be operated only if 12V power source is connected.

1 When winding line other than Shimano Antares 50lbs.-600m (See P.9-10)

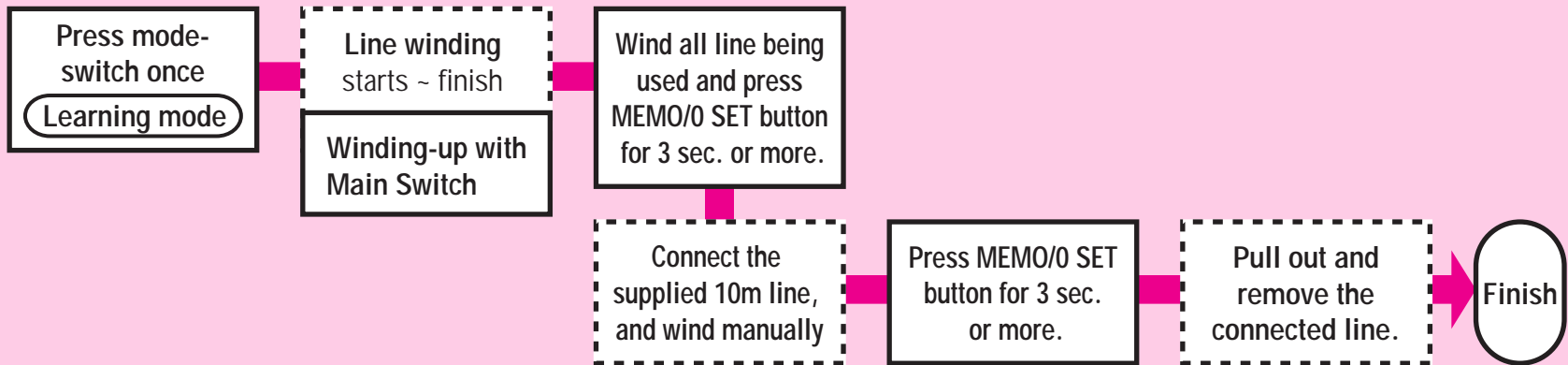

2 When Shimano ANTARES 50lbs.-600M can be wound (See P. 11)

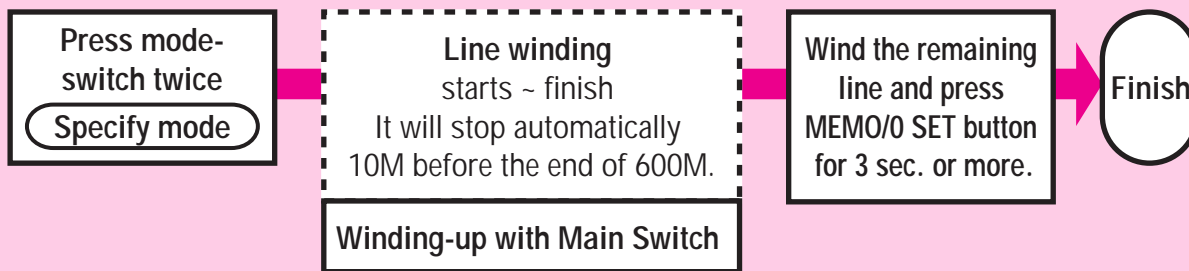

Learning Method (The actual figure of the line used will be memorized in the reel)



1 When winding line other than Shimano Antares 50lbs.-600m (use Learning mode).

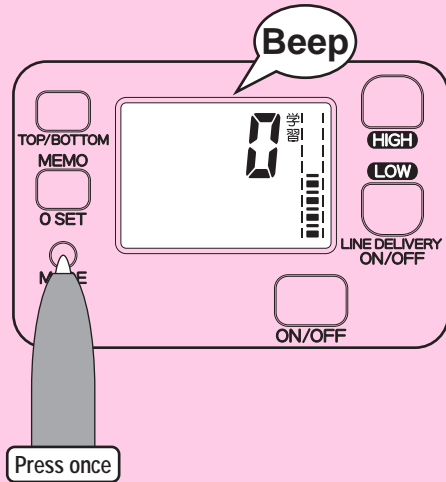

1 Switch on the clutch lever. Then check power connection. When the mode-switch is pressed once with something that looks like a ball pen, “学習 (Learning)” will be displayed, and you are in Learning mode. If you press the mode-switch more than twice, it will turn into Specify mode or Down-winding mode. To return to Learning mode again, you have to press a few more times.

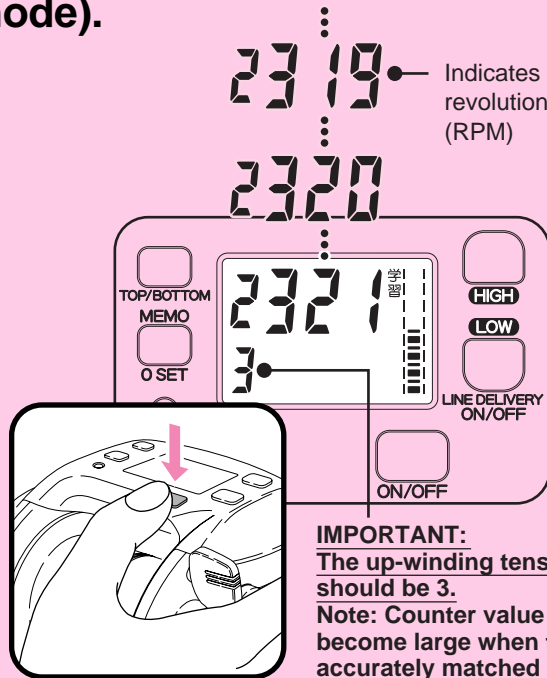

2 Press the Main switch, and wind the line. The RPM will be displayed. Line tension is shown at left-bottom, adjust till you get figure 3. (Using a wet towel apply tension and wind the line. Do not apply tension with bare hands. Doing so can result in injury.) The figure shows the tension of winding-up line, and expressed in figure. The figure is not equal to kg.

IMPORTANT:
The up-winding tension should be 3.
Note: Counter value error will become large when tension is not accurately matched during learning.



Winding speed can be adjusted with speed button. When you want to stop the winding, press the main switch one more time.
※ When the remaining line is short, the line end (above drawing) should not be wound in. Be careful here. If necessary, use your hand to wind. If the end is wound, correct input becomes impossible to get.

Continue to Next Page

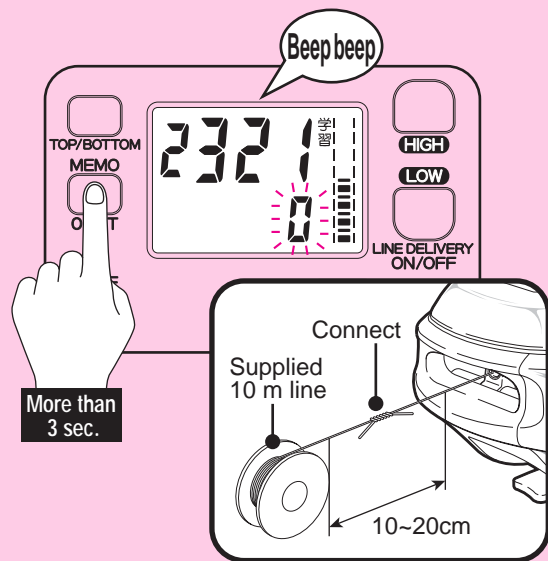

- 3** Connect the end of the line already wound to the supplied 10m line.

- 4** After positioning in the physical relationship of the figure, press the MEMO/0 SET button for 3 sec. or more once the winding has been fully completed.

The display will be as shown above.

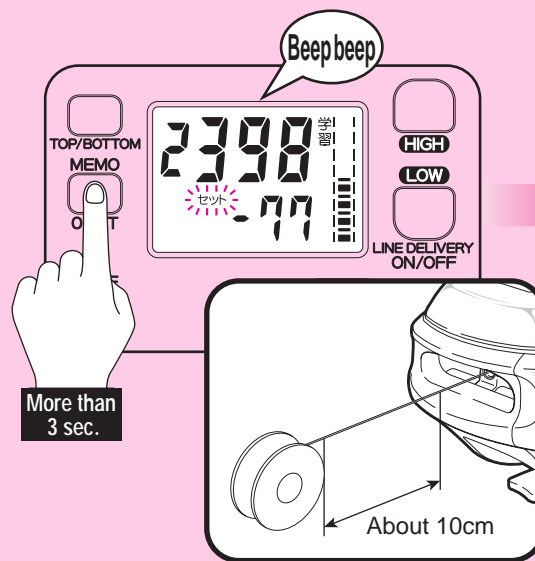

- 5** Wind the newly connected 10M line manually.

The RPM is shown one step lower.

To end Learning, press the Memo, 0-setting button for more than 3 seconds. “セット (Set)” will appear.

※ If the mode switch is pressed by mistake while the input is being done, the data half-done will all be cancelled. In that case, pull out the line, and re-do from Step **1**.

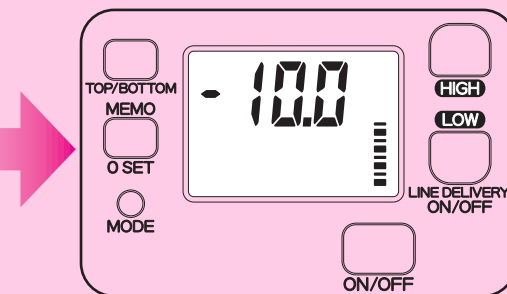

- 6** The display returns to Top Mode.
(The figure from the counter and the actual line length may differ by a max. of 3%.)
- 7** Wind up the 10M line that has been pulled out.

Precautions: When winding line such as Nylon, the inaccuracies of counter may exceed 3%.

Note: Learning inaccuracy may result in count error.

Learning Method (Line data input can also be used)



2 When Shimano ANTARES 50lbs.-600M can be wound (use Specify mode)

This reel carries the input data of Shimano ANTARES 50lbs.-600M winding.
When winding this material, use the following operation.

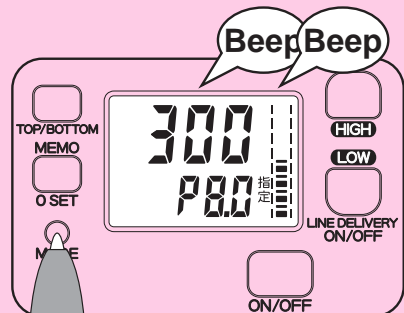

Note: The display monitor depicted is that for the Japanese model.

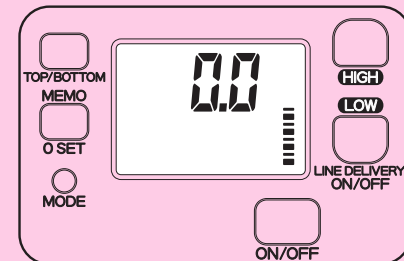
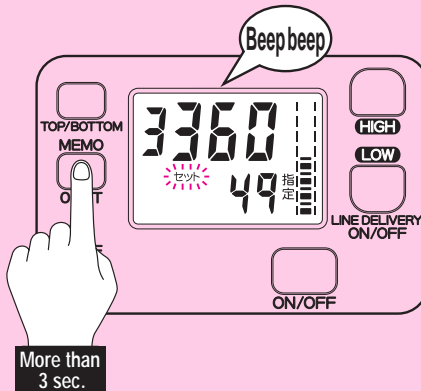
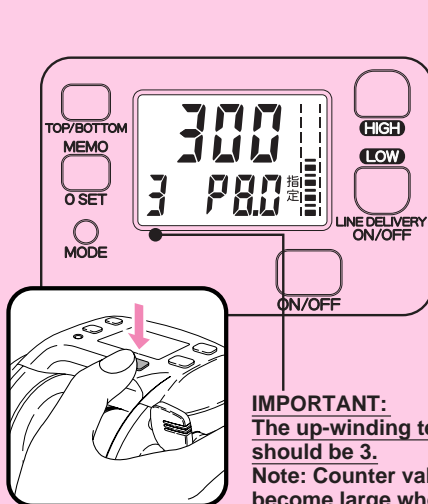

- 1 Press mode-switch twice with something that looks like a ball pen.**
“指定 (Specify)” will light up as shown in the above drawing, you are in Specify mode.
If you press the mode-switch more than twice, it will turn into Down-winding or Learning mode. To return to Specify mode again, you have to press a few more times.

- 2 Now we start winding the line.**
Do the winding with line tension showing 3. It will stop automatically 10M before the end of 600M.
(Using a wet towel apply tension and wind the line. Do not apply tension with bare hands. Doing so can result in injury.)
Wind the remaining 10M manually.

- 3 When line winding is complete, press Memo, 0-setting button for more than 3 seconds to end Learning.**
The display is shown above.
※ If the mode switch is pressed by mistake while the input is being done, the data will be deleted. In that case, pull out the line, and redo from Step **1**.

- 4 The display returns to Top Mode, and Learning ends.**

Precautions: When using line other Shimano Antares 50lb.-600m, the inaccuracies of counter may exceed 3%.

Note: Learning inaccuracy may result in count error.

Sequence (for faster, effective use of 4000 HP)



Simple

Once I know this, I'll be able to use it.



Convenient

Simple and convenient



Even more Convenient

The more you know, the wider your fishing world



Zero-setting

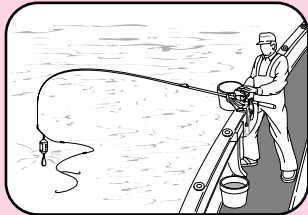

When the hook is on the water surface, by pressing one button only, 0-meter setting is done. Hook can be dropped to the exact depth.

For details, see P.16



Line cut

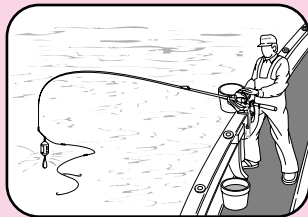

Re-connect hook, lower it to water surface, and press 0-setting button for more than 3 sec. Simple way to get cut line restored.

For details, see P.18



Gunnel stop

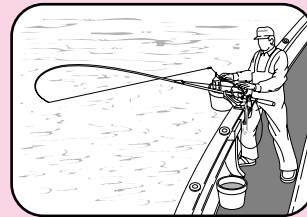

Erect pole and the hook will come back to you at exact position. The gunnel stop function will secure it.

For details, see P.19



Motorized up-winding

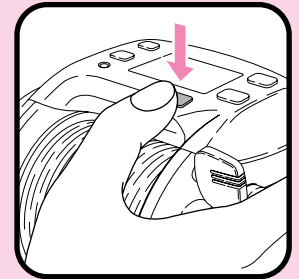

To change bait, or when it hit something, just press the Main Switch to up-wind easily.

For details, see P.21



※ There are 3 main types of functions in 4000 HP. Select one that suits your fishing method.



One-touch

Speed Switch

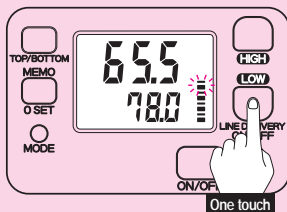

One touch alone will enable you to select from 15 speeds.

For details, see P.21

.....



Rack memory

Hook-setting

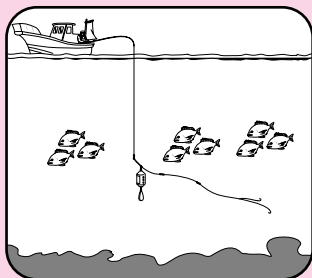

The depth of rack is automatically memorized. You can reach exactly the same depth each time. Manual setting is also possible.

For details, see P.22

.....



Top & Down

Switching between Top Mode and Bottom Mode

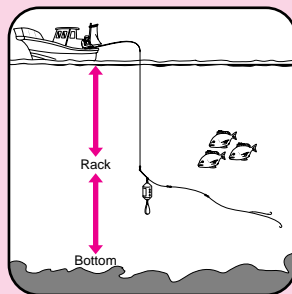

Depending on fishing area, fishing method, and target fish, the counter display can be switched between "Bottom Mode" to "Top Mode". Rack water depth is known immediately.

For details, see P.23

.....



Application 1

Technique to drop hook fast.

(Effective when you are looking for squids)

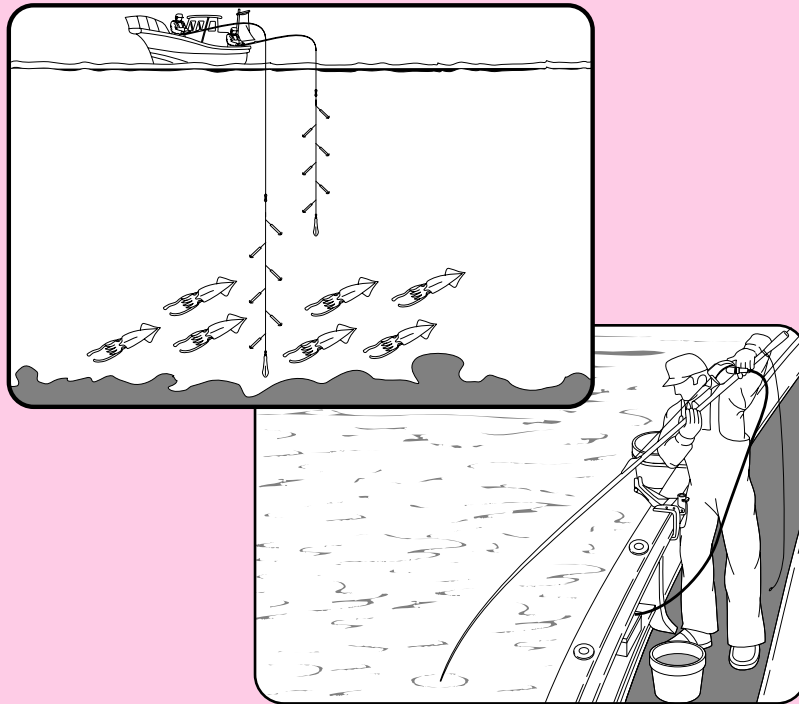

- Normally, by tightening the spool control knob, the spool free-spinning becomes a bit sluggish, and depending on vessel's up-down movement, backlash can be prevented.

- However, to drop the hook faster, do not use the knob, use your finger instead.

Apart from that, the following methods can also be used.

- Use the auto-line delivery function of this Dendoumaru 4000 HP. When the hook drops more than 10M, the Motor Switch will be ON automatically. As a reaction to the turning of motor, the spool will turn in the direction the line comes out.

When you return the clutch, the motor will stop turning automatically. And, when you press the Main Switch while the line is being delivered, the delivery will stop.

- Aim the pole tip downward. By erecting the whole pole, you can reduce the guide resistance.

- The auto-line delivery function is factory-set. If you want to delete it due to guide resistance and backlash, press the lower part of the Speed Switch for more than 3 seconds. “糸送り” (Line delivery stop) indicator will light up, and the function cancelled.

(Speed display will return to its original state).

When you want to use the function again, repeat the operation. Before you repeat it, the status will continue to show “糸送り” (Line delivery stop) even if the power is cut off.

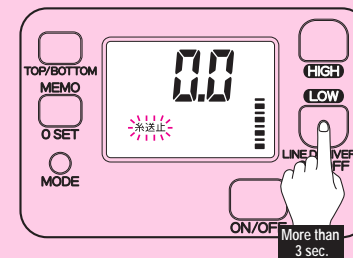



Application 2

Technique to retrieve hook fast using motorized plus manual method.

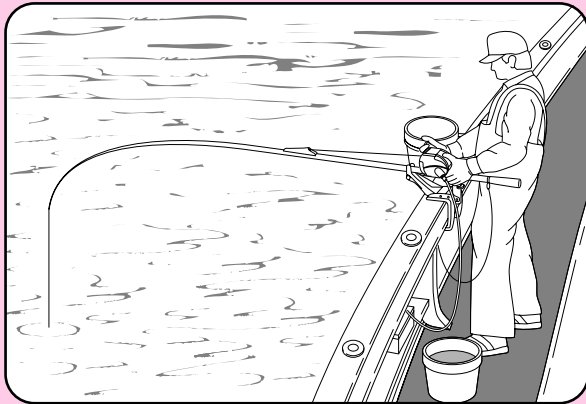

This is the technique to wind empty hook fast when retrieving or changing fishing point. Select high speed on the Speed Switch. Besides motorized winding, use your hand to wind too to speed up. (When doing that, it is easier to have the rod-keeper attached to the pole).



Application 3

Technique to avoid fish from scattering during motorized up-winding.

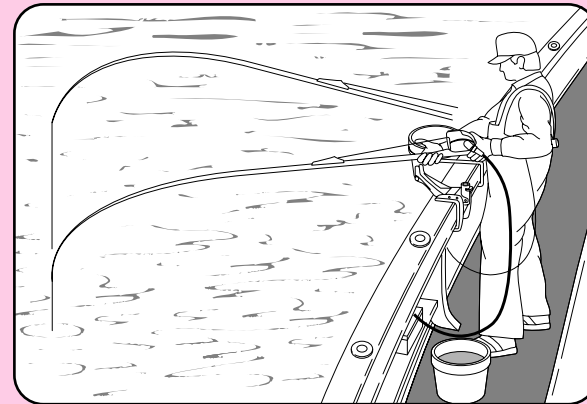

Motorized method is smoother than manual during up-winding. In addition, when using this technique the fish will not be scattered.

- Remove pole from rod-keeper, and hold it with your hand.

- Adjust the drag so that the motorized up-winding is a bit slippery with the vessel's up/down movement and the pull of fish.

- Move the pole-tip up and down to absorb the vessel's up/down movement due to wave. By doing that, the up-winding speed is more stable.

Zero-setting (Always do it before you start fishing)

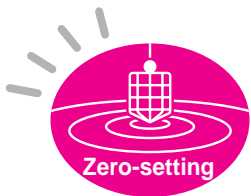

To reach the rack exactly.

To improve your catch result, it is essential to get to the rack exactly.

To do that, do zero-setting.

Zero-setting means setting of 0-Meter

when the hook is on the surface of water.

By doing zero-setting, the rack depth can be reached exactly as the rack position depth is displayed.

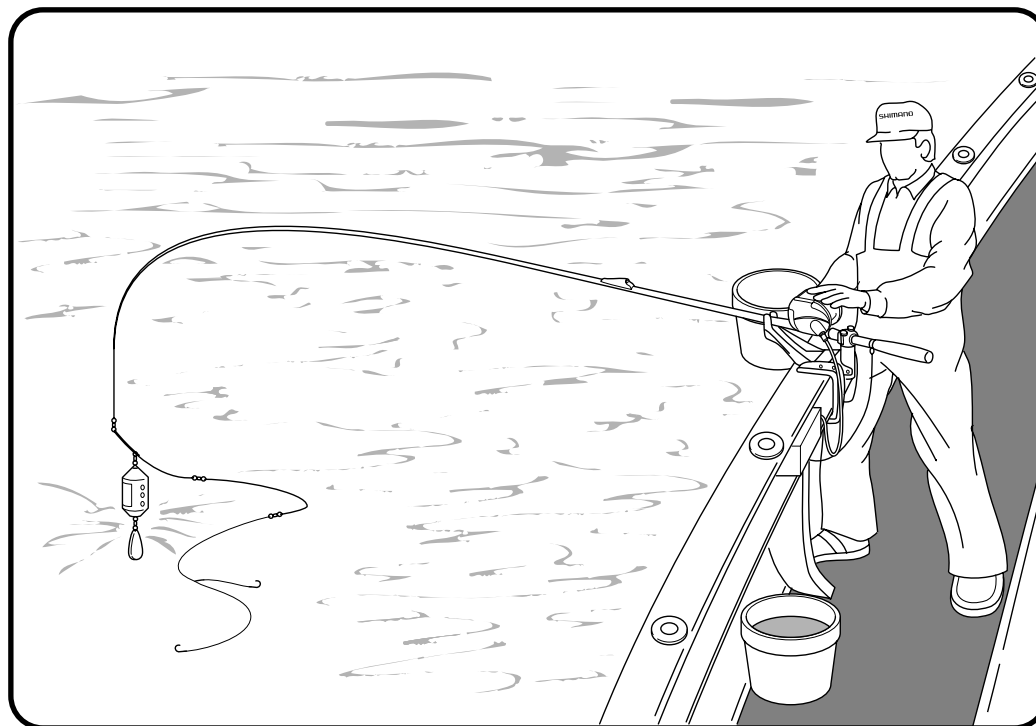

When the hook is on the surface of water, do the zero-setting

Let's try to do zero-setting.

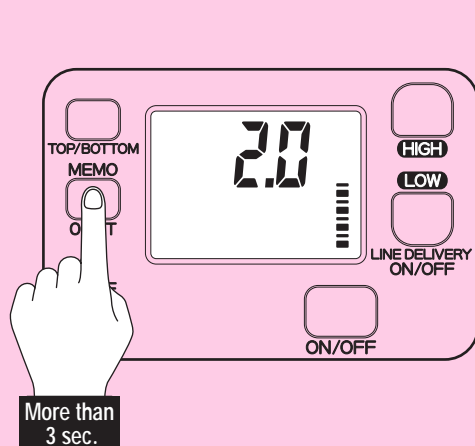

- 1 Adjust the hook to water surface, and press 0-setting switch for more than 3 sec.

(Above drawing shows the Top Mode)

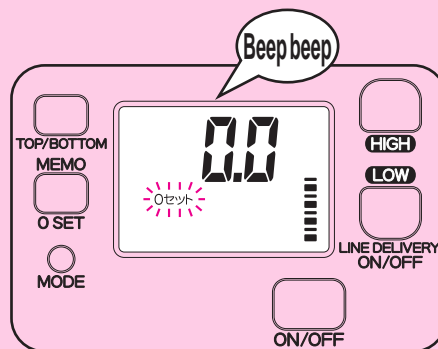

- 2 As shown above, the display has changed.

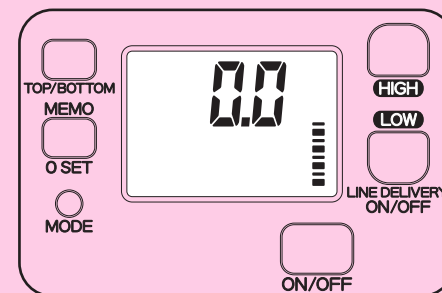

- 3 When "0セット (0-set)" disappears, it means 0-setting is complete.

Line-cut repair



When there is a line-cut, repair can be done easily.

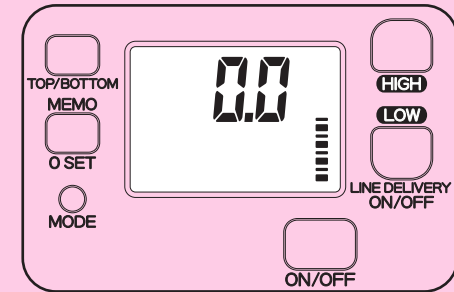
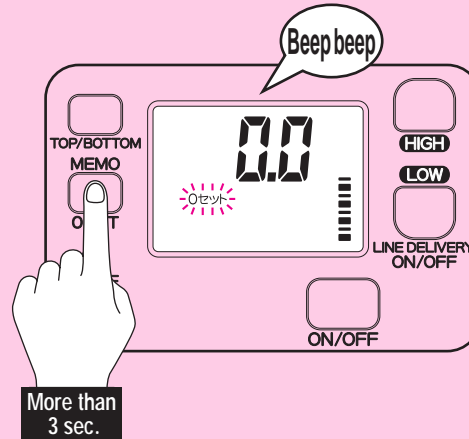
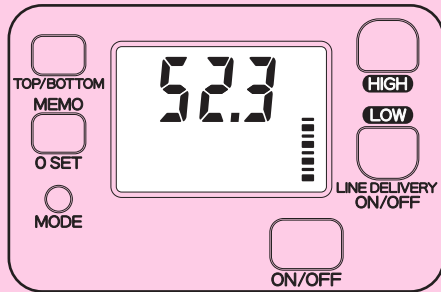

- 1** Up-wind till the position the cut occurs.
- 2** Set the hook and adjust to the water surface, and press 0-setting switch for more than 3 sec.
- 3** By doing that, the computer will change the program automatically according to the actual measured value displayed from the point of cut.

Gunnel stop



After motorized up-winding has stopped, when the pole is erected, the hook will stop in front of you.

After gunnel stop, when the pole is erected, the hook is set to return automatically to the position in front of you.

※ After the power is ON, initially it will stop 6M from the gunnel. From the 2nd time onwards, the computer will judge automatically the previous stop position of hook.

(This function works within 1-6M).

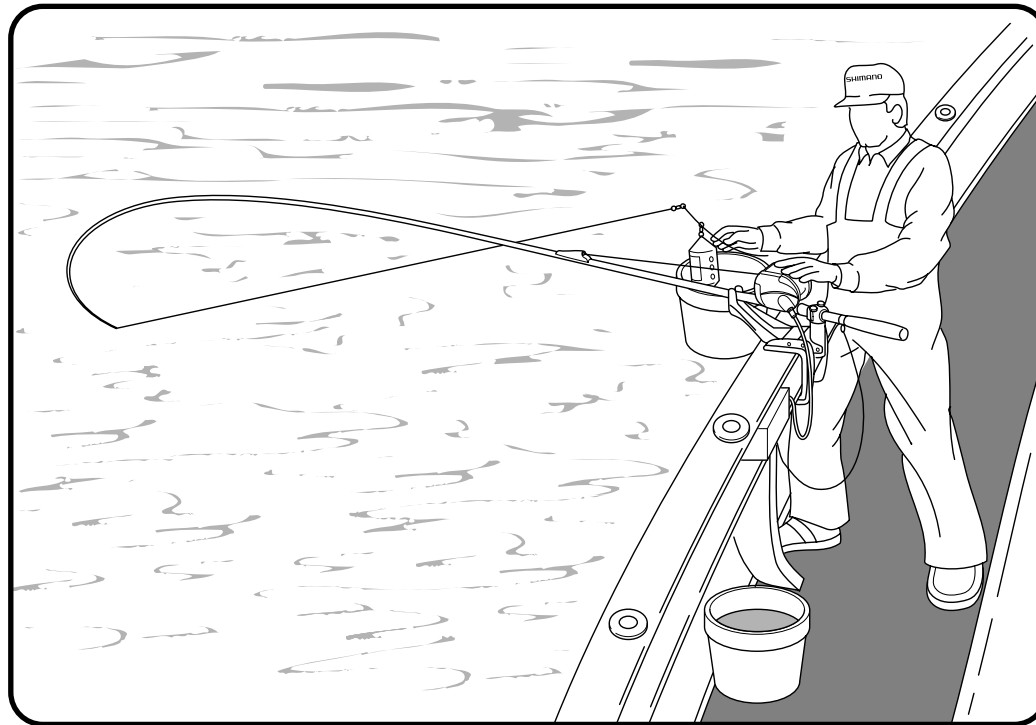

4 Meter from gunnel stop position, the alarm will sound (Beep).

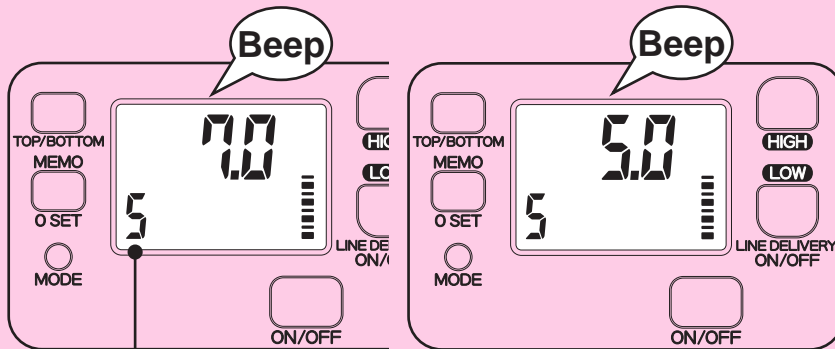

The number changes according to the load.

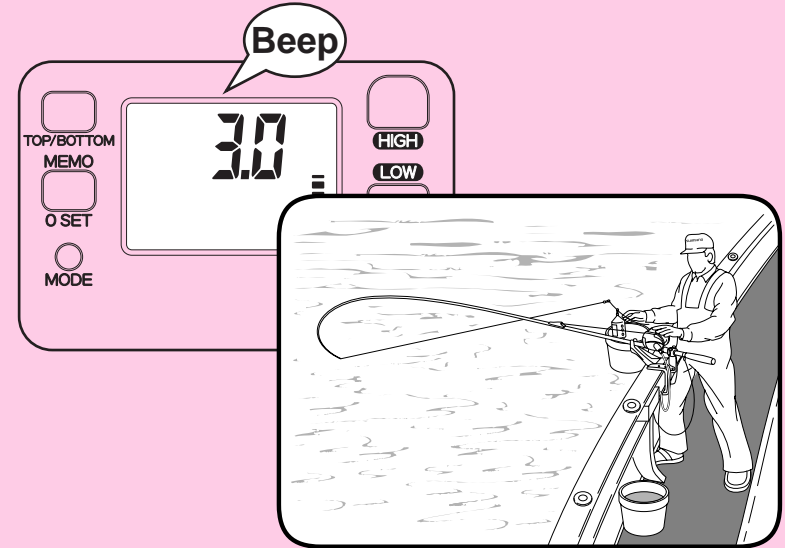

1 4 meter from the stop position at the gunnel, alarm will sound, after that at each 2 meter.
(The drawing shows Top Mode)

2 Gunnel stop position (in this case 3.0m) : alarm will sound twice, and winding stops automatically.
After gunnel stop, by erecting the pole, the hook will be in front of you to pick up promptly as shown in the above drawing.

Motorized up-wind & speed-switch usage

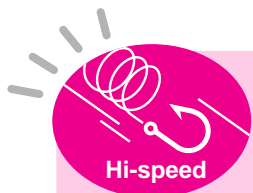

Winding up using motor power. The most basic operation.

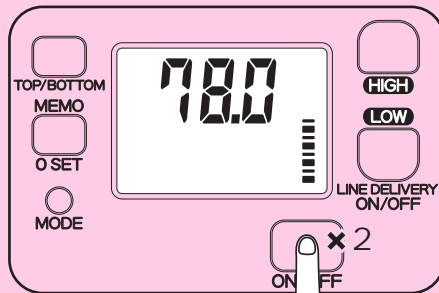
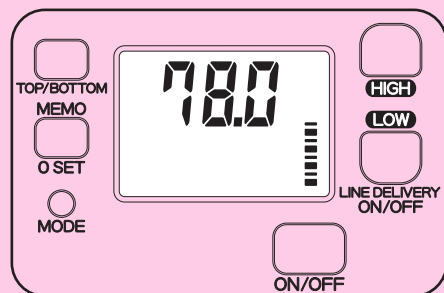

Double-click



Here will appear set of motorized up-wind

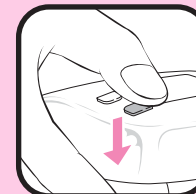
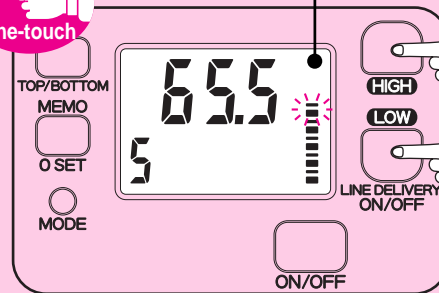

Press this to wind faster

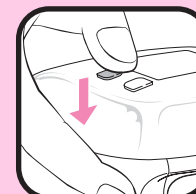

Press this to wind slower

Continuous winding

Double-click



Speed indicator mark changes like this.



1 Drop the hook, and switch ON the clutch. (Above drawing shows Top Mode)

2 When replacing bait, or when it hit something, press the Main Switch twice continuously to wind up with motor.

3 Adjust up-winding speed with Speed Switch. For bait replacement, or clearing obstruction, it can be done fast for faster return.

To switch to double-click mode...

Press the HIGH and LOW buttons at the same time for 3 sec. or more to exit the continuous wind-up mode and allow double-click operation.

To return continuous wind-up mode, press the HIGH and LOW buttons again at the same time for 3 sec. or more.

Rack setting



Putting the hook exactly at the rack will increase efficiency sharply.

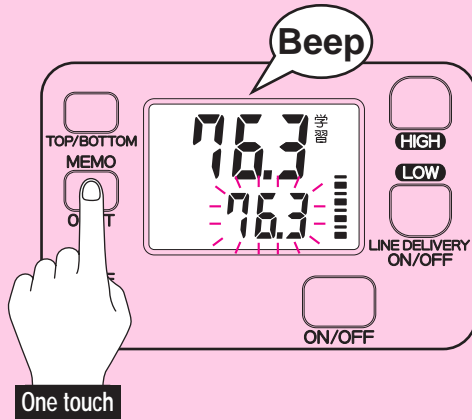

Lower the hook to the depth to be memorized (more than 6.1m), then press Memo Switch for less than 3 sec.

Above drawing shows water depth of 76.3m for the rack. This setting can be changed any number of times you like.

When the memorized water depth is greater than 10.1m, "Memo Alarm" will announce when the hook reaches that position.

(Both Top Mode and Bottom Mode)

Precautions:

When Memo is not pressed, normally it will not be displayed.

Two-way handling of rack: from top and bottom



For convenience, it can be from top or bottom.

The trick to improve catch result is to drop the hook exactly to where the fish is (the rack).

The latest high-performance fish group sensor can detect the exact water depth of fish.

Normally, the vessel captain will advise the position of this rack. In this case, depending on fishing area, fishing method, and the catch expected, the rack can be indicated from the water

surface, or from the bottom (ocean floor).

The NEW DENDOUMARU 4000 HP has both the convenient “Top Mode” to indicate from water surface, or the equally convenient “Bottom Mode” to indicate from the bottom. Alternate these two modes to suit your fishing purpose.

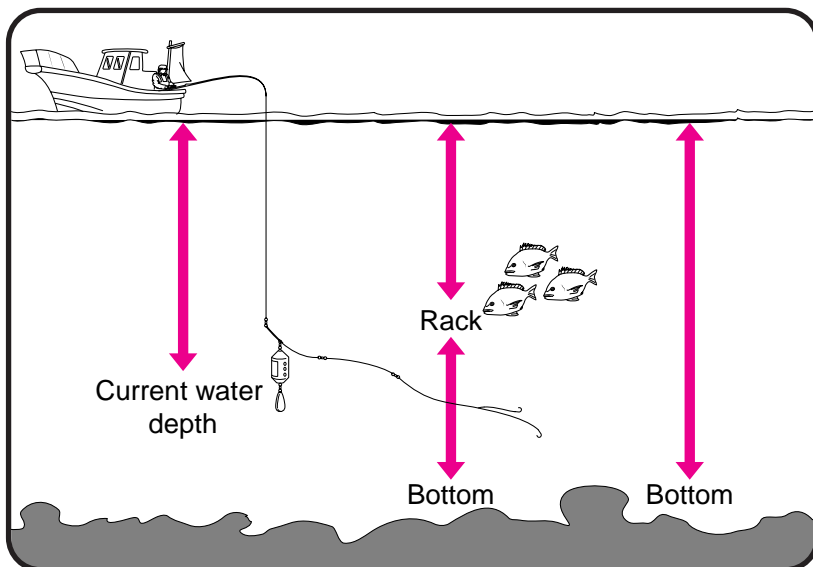

Mode Switching....

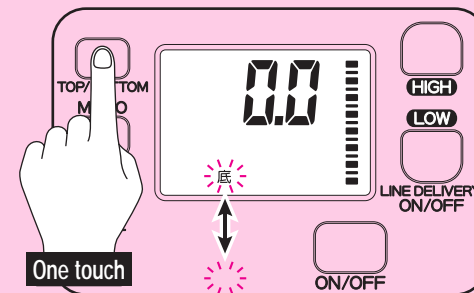

● **Press the Top/Bottom Switch.**

The Top Mode and Bottom Mode will switch alternately.

If “Bottom Mode” is selected, “底 (Bottom)” indicator will light up.

For “Top Mode”, there is no indicator.

Top Mode fishing example

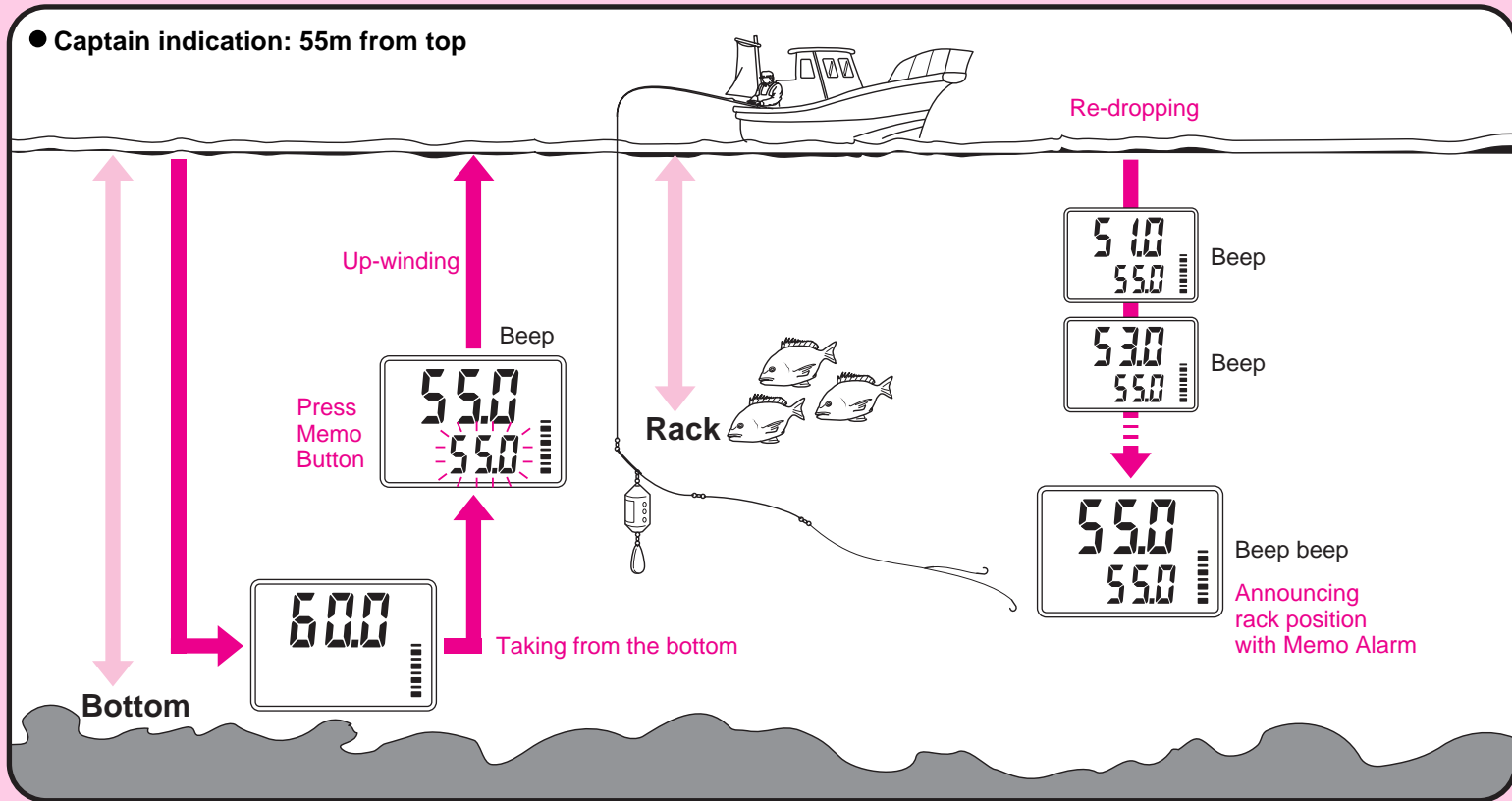

- 1 Drop the hook to the bottom first.
- 2 Wind the hook and bring it up to the rack.
(Above drawing shows Top Mode)
- 3 Press the Memo Switch to memorize the rack position
- 4 When re-dropping, "Memo Alarm" will announce when the hook has reach the rack position.

Bottom Mode fishing example

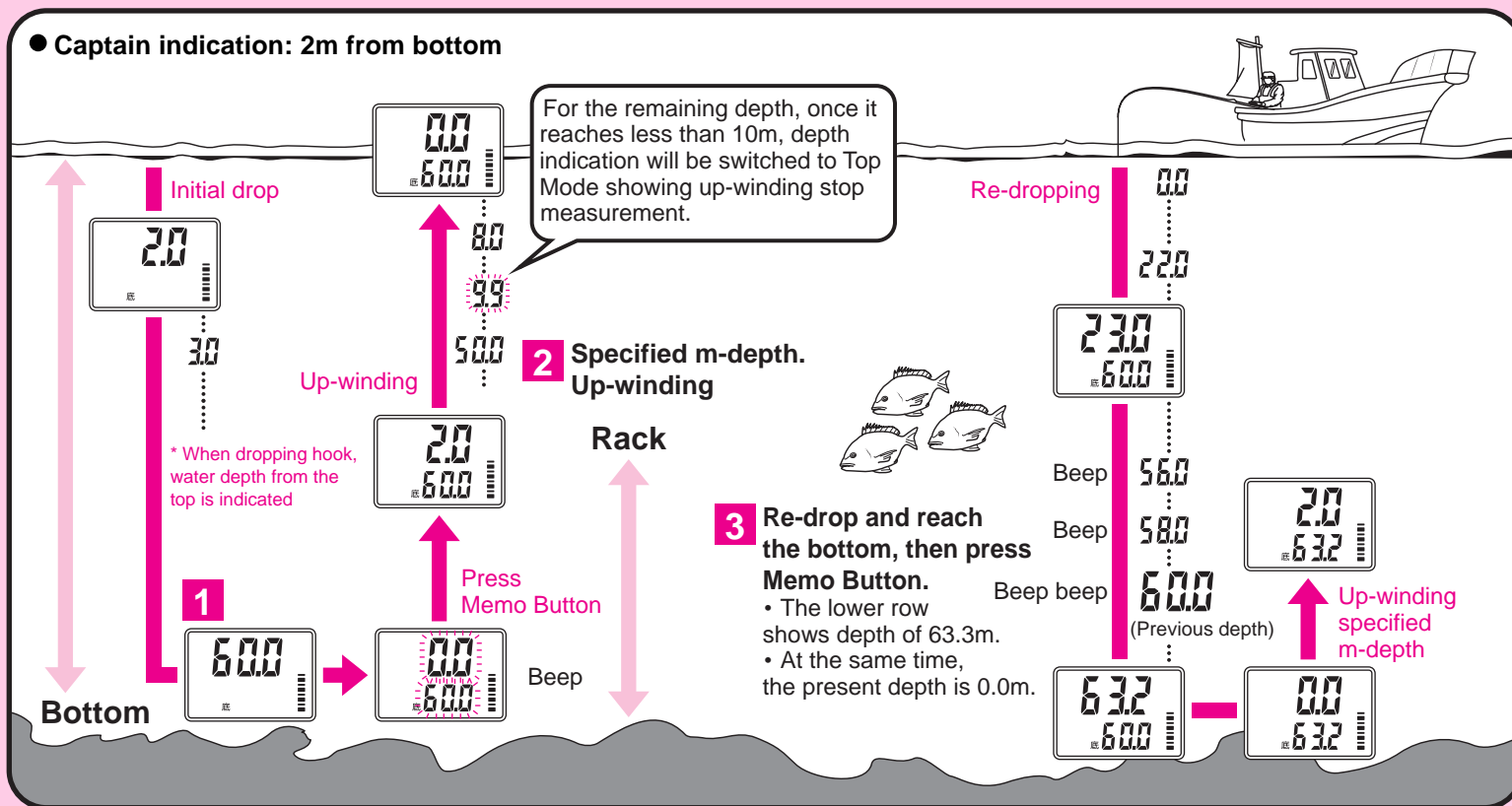

1 Drop the hook to the bottom first.

- The lower row shows the depth from top.
- At the same time, the present depth is 0.0m. When the reel winds up, it becomes a positive count indicating the depth from the bottom.

Explanation: When the Captain says “So many meter from the bottom”, you drop the hook first to the bottom, and wind the hook up for the meter specified.

(Normally they wave during this moment)

At fishing area where the fish follow the bottom contour, when dropping the hook, go right to the bottom first before coming up again to locate the rack.

Handling precautions / Safety Features

DENDOMARU is built with precision components, so please pay attention to the following when handling it. And after your fishing trip, do take care of it for long-life use.

1 Reel protection

- Dirt that sticks to the reel of Dendoumaru 4000HP has to be removed, and the bearing can be oiled.

Preparation: Reel, neutral cleaning solution, sponge.

1. Remove dirt with cleaning-solution-soaked sponge, and tap water.
2. Rinse down the cleaning solution. Hose down between spool and the unit, then disengage the clutch and pull out 2-3m of line. (Refer to drawing on the right).
By doing that, salt content that sticks to spool bearing will be removed.
3. Dry it up.
 - * Do not immersed in water to wash.

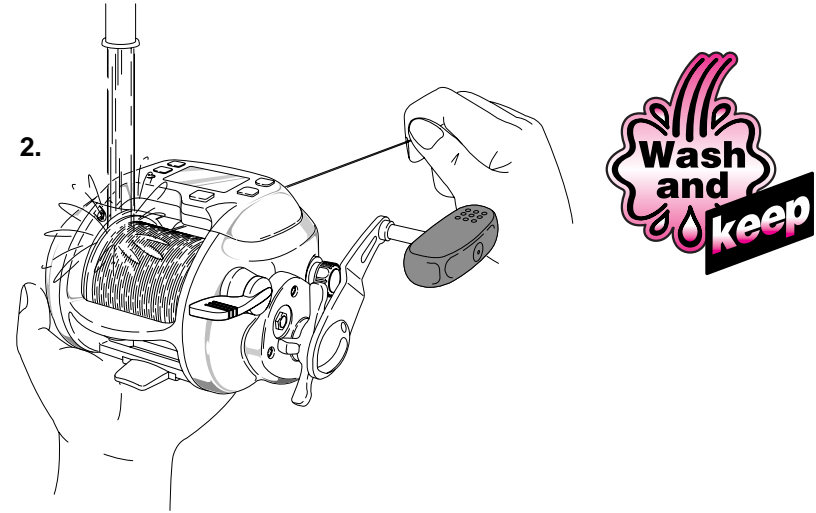

2 Use precautions

- When stuck, do not pull the pole or reel with force. Use towel to cover it and leave no line at fishing area if possible when you pull it out.
- Handle the reel carefully. When shifting position, especially when leaving, take care not to cause damage due to friction with other tools in the bag.
- Do not drop and avoid shock to the reel.
- During erection on the boat, when short of space, do not subject the back side of the reel and power cord to shock. And do not fold or bend the cord, especially when the cord is in-between the reel and gunnel.
- Depending on the deflection of glass, the counter LCD screen may not be clear.

3 How to maintain

- To prevent rust on the connector, cover it up when not in use with the cap for water prevention.
- Dirt and sand that stick to the component should be removed, then dry it. And do not immerse in water. Do not use volatile solution such as thinner, benzene, etc.
- Do not dismantle the reel. Inside there are motor, breaker, and other electrical components. It may cause damage.
- Do not apply oil to the drag area. Otherwise the drag capability may drop.
- If you keep for long at a place with high temperature and high humidity, the shape may change and the strength deteriorate. For long period storage, after the above maintenance has been done, keep it in a location with good ventilation.

4 Safety features

- **Self-recovering breaker**
When the motor is overloaded, to protect the motor, the breaker will work. When the breaker works, and when it recovers, there will be alarm sound announcement. When the breaker works, all indicators will blink as shown on the right.

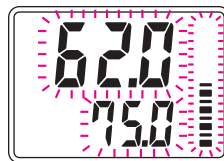

- When doing your own dismantling or repair, do not get your fingers cut by the sharp edge of component.
- The reel unit, especially the counter, should not be immersed in water. (The counter is water-proof under normal specification, but to avoid trouble, do not immerse in water).
- The reel you have now is meant for long life service, and a special grease has been made for that purpose. Apply it through the two holes of power cord terminal as shown in the drawing.

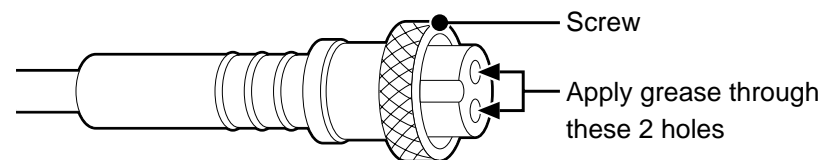
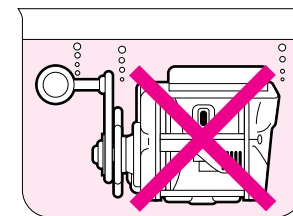

- **Battery detection indicator**
When battery voltage drops (approx. 10.5V), cord and connector contact will be affected, and the battery icon will blink. **(Drawing A).**

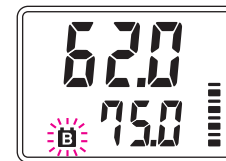

(Fif. A)

And, when the voltage is above DC 21V, "Err" will appear. **(Drawing B).**



(Fif. B)

5 Specifications

Model	Code	Gear ratio	Max. drag (kg)	Weight (g)	Line vol using Shimano ANTARES	Max. winding speed (cm/handle 1 rev.)	Motor up-winding speed (m/min.)	Spool (mm) (dia x width)	Ball bearing
Dendoumaru 4000HP	1RG154000G	3.1 :1	13	1180	50lbs.(0.32m/m)-600M	65	Max. speed 150+130~10-14 speed. Total 15	68/61.5	1

Supplied accessories: Cord, cloth bag, instruction manual, exploded parts diagram, line pin, grease, oil, 10m line.

6 Power source

The power source is direct current (DC) 12V. (Capacity above 16,000mAh). Unspecified power source such as household AC

100V, vessel DC 24V cannot be used.

Battery charger also cannot be used absolutely.

7 Product inquiry, After-Sales-Service

Explanation of reel mechanism may not be too clear on paper. For inquires through letters, always provide your telephone number.

- When you send for service, leave it at the shop you purchased from. In such case, always describe the repair position, trouble (e.g. the stopper does not work)."

And, when there is no Shimano sales agent nearby, contact our Head-office or Fishing Tool Service Dept.

Please understand that for servicing, besides spare-parts fee, service fee is chargeable.

- When you repair by yourself, please refer to Detail Drawing to place an order for spare-parts and spool, describing product name, product code, spare-parts no., and spare-parts name. (For internal parts, as they are complicated, we recommend that you leave the repair of the reel to us.

Example:

Product name : Stella 1000

Spare-part No. : 2

Product code : SC66B010

Spare-parts name: Spool

● Product code

The product code is printed on the Instruction Manual, Detail Drawing, Package bottom, and the Product itself (the first 5 digits)

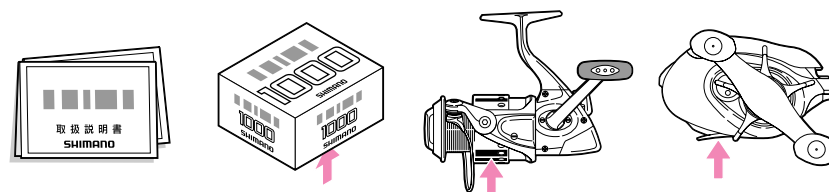







Troubleshooting

Problem	Solution	Reference
LCD totally black, and all characters appear.	When exposed to high temperature environment (like in car trunks), it may happen. Reduced the temperature and it will return to normal.	
Even when connected to 12V battery, there is no LCD display.	Check if battery and power cord's (+) and (-) terminals are connected properly. Also check if battery capacity is sufficient.	P.6
Line winding learning is not set.	It's a bit troublesome, but return to learning, and check.	P.7-P.11
Even if line has been delivered, the counter does not move.	It's a bit troublesome, but return to learning, and check.	P.7-P.11
The error is large.	It's a bit troublesome, but return to learning, and check.	P.7-P.11
The counter display and line water depth color does not match.	Depending on type of line, there is some difference, but due to line stretch during use, it may not match counter display because of slip.	
The gunnel stop position is different.	It may be caused by up-winding tension and line stretch. Do zero-setting on the surface. And for the set that can memorize gunnel, the range is 1-6m. Sets that has 0-1m setting range should be set at 1m for safety reason.	P.16-P.17 P.19
There is display on the LCD, but the motor does not work.	Check if the battery capacity is sufficient. * If it works when the motor speed is low, but not when the speed is high, then it's may be due to battery capacity. Check again after battery re-charge. But if after re-charging it still doesn't work, then the battery is probably too old. Use new battery and check again.s may be due to battery capacity. Check again after battery re-charge. But if after re-charging it still doesn't work, then the battery is probably too old. Use new battery and check again.s may be due to battery capacity. Check again after battery re-charge. But if after re-charging it still doesn't work, then the battery is probably too old. Use new battery and check again.	P.6
The motor stops in the midst of up-winding.	Check if the screw of power connector is properly tightened. The terminals of vessel power source and the connector of reel and power cord may be rusted causing poor connection. Check again after removing the rust.	P.6

If it still does not work after the above has been done, then bring it to the dealer you purchased the set from. Fill in the Repair Card and if possible describe the problems and send to Shimano Service Center.

Read it before you use.

 WARNING	
	<ul style="list-style-type: none">• When using motorized reel, a very weak frequency will be dissipated. It may affect the function of medical device such as hearing aid and pacemaker. It may affect the user's movement and visibility, especially for user that carries heart pacemaker, so please consult a doctor, the medical device maker or dealer on the effect of this motorized reel before using it.• Do not put your finger close to level winding position where the line is led in.• Do not get your finger pressed between the reel body and its handle, it may cause injury.
	<ul style="list-style-type: none">• Use only specified voltage (12V) from battery or vessel power source. When you use different voltage, the motorized reel may heat up and your hand burnt.
 PRECAUTIONS	
	<ul style="list-style-type: none">• Do not touch the spinning spool. It may cause injury.
	<ul style="list-style-type: none">• Do not dismantle or modify the motorized reel. It may cause damage or accident.

SHIMANO

SHIMANO EUROPE FISHING HOLDING B.V.

Industrieweg 24, 8071 CT Nunspeet, The Netherlands Phone: +31-341-272222

SHIMANO (EUROPA) GMBH

Diessemer Bruch 114 F, 47805 Krefeld, Germany Phone: +49-2151-55670

SHIMANO U.K. LTD.

Unit 1A, Vale Park Business Centre, Vale Park, Evesham, Worcestershire WR11 6GN, United Kingdom Phone: +44-1386-425820

SHIMANO ITALY FISHING S.R.L.

Via Privata Maestri del Lavoro 29, 20025 Legnano Milano, Italy Phone: +39-0331-742711

SHIMANO AMERICAN CORPORATION

One Holland, Irvine, CA 92618 U.S.A. Phone: +1-877-577-0600

SHIMANO CANADA LTD.

685 The Queensway, Peterborough, Ontario K9J 7J6, Canada Phone: +1-705-745-3232

DUNPHY HOLDING PTY. LTD.

UNIT1, Block A, 1-3 Endeavor Road, Caringbah, NSW 2229, Australia Phone: +61-2-9526-2144

SHIMANO (SINGAPORE) PTE. LTD.

20 Benoi Sector, Jurong Town, Singapore 629852 Phone: +65-6265-4777

SHIMANO INC.

3-77 Oimatsu-cho Sakai Osaka 590-8577 Japan Phone: +81-72-223-3957



This manual uses recycle paper.

04



PRINTED IN JAPAN
IMPRIMÉ AU JAPON
(030225)

SHIMANO